

Manulife iFunds: A Quick Guide

How do I make a transaction?

You can manage your portfolio anytime, anywhere by logging into your Manulife InvestChoice account.

You can place your instructions by clicking on the menu button at the top right hand corner and select the transaction type you want.

Your Manulife Investment Fund Intermediary can always guide you through all of the required steps.

Subscription

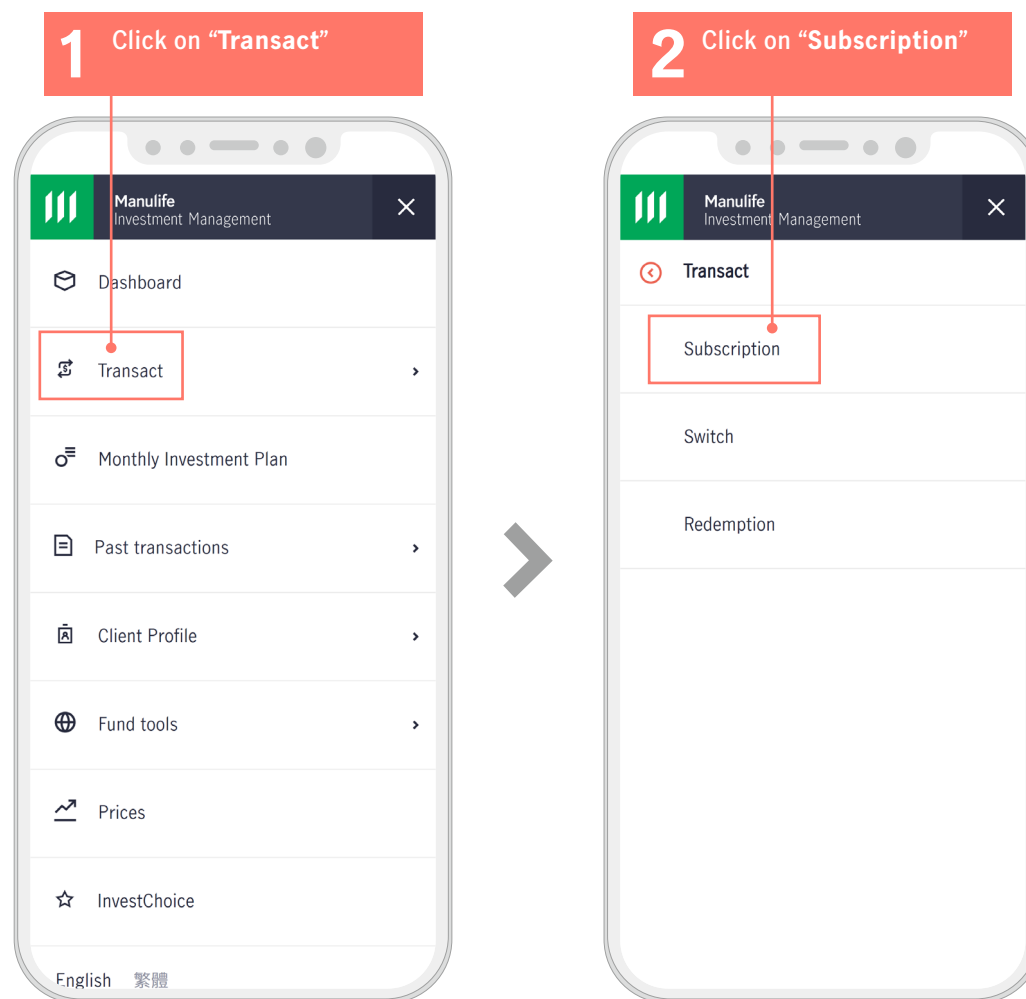

3 Answer a question about your fund selection process

Subscription

Account holder
Chan Tai Man

Account number
1030416990 (Trade-based Account (Single-name))

Available balance
No available balance

Before you proceed

Your fund selection process depends on your ticked option below.

☒ I/We make this instruction solely based on my/our own judgment and decision

☐ I/We make this instruction based on discussion with my/our Manulife Investment Fund Intermediary

Next

4 Search fund by inputting fund name in the search bar

Step 1 | Select your fund subscription

Fund Selection

There are 19 funds available for you, you can select by search, sort and filters. ⓘ

View: Available funds | All funds

manulife ✕ Sort and filter

Manulife Hong Kong Series - Manulife STARS Income and Growth Fund ✓

Manulife Advanced Fund SPC - Asia Pacific Income and Growth Segregated Portfolio ✓

Manulife Advanced Fund SPC - China A Segregated Portfolio ✓

The Fund Risk Level is higher than your Risk Profile.
The Fund does not match with your investment objective.

Class AA USD

Remarks: Funds that do not match with your client profile or risk appetite will be greyed out and not clickable

5 Search fund by using the sort of filter function with different parameters such as asset class, eligibility scheme and risk level

Sort

Fund name manulife

Filters (0)

Asset class

All Bond Equity

Multi asset/Other

Eligible Scheme

All CIES

Risk level

AA USD

Apply

6 Select the fund and the share class

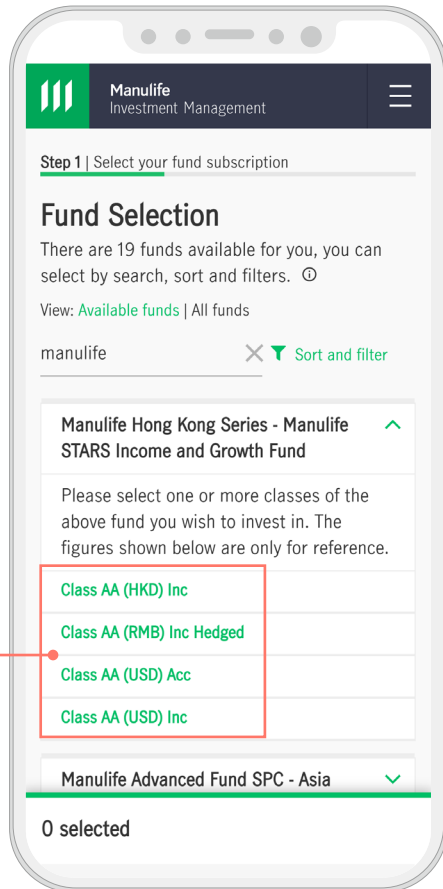

7 View the basic information of selected share class will be shown. Click on "View details" for more information

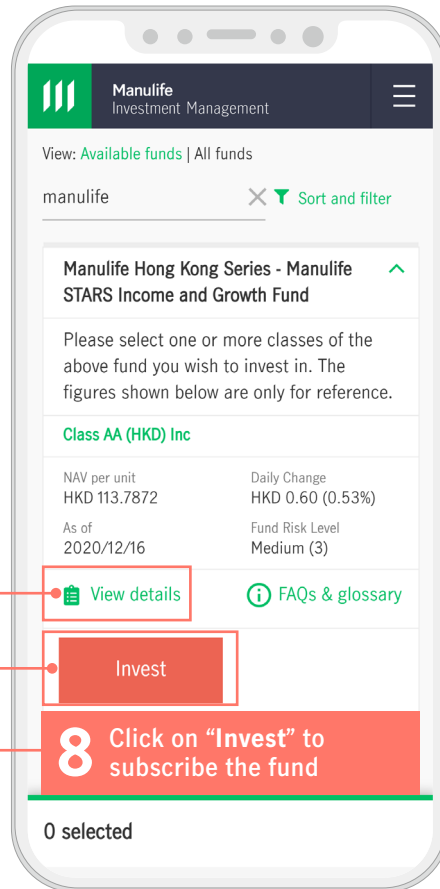

8 Click on "Invest" to subscribe the fund

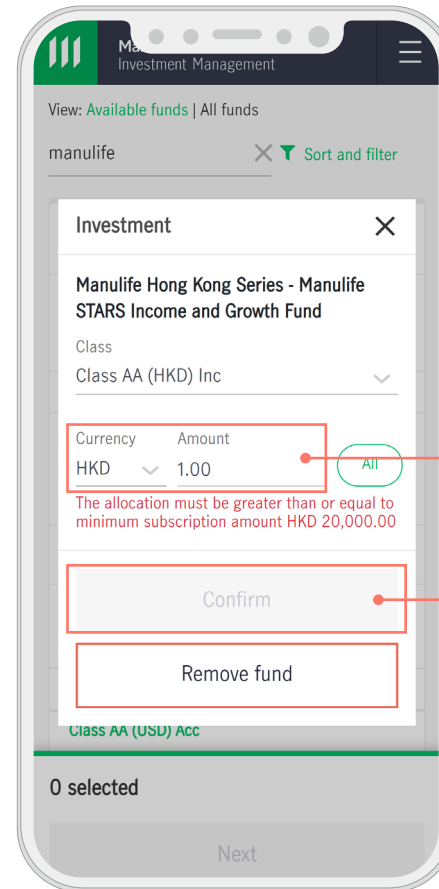

9 Enter your investment amount and currency (The system will alert you if the input amount is lower than the minimum subscription amount.)

10 Click on "Confirm"

11.1 Selected fund will be shown at the bottom. You may repeat step 6-10 and add fund to subscribe. Then click "Next"

11.2 Review the transaction details, enter the promo code (if any) and give the necessary consent, then click on "Confirm" to proceed

12 Receive a thank you page with a reference number

Remarks: Reminder will be shown if the instruction is given after cutoff time.